

CzechyWęgry

# GLP Park Brno Vyškov

40,800 SQM

## KEY FEATURES

BREEAM Excellent

Oświetlenie LED

Nasadzenia

Odzysk wody

Pompy ciepła

Smart metering

Zapytaj o tę nieruchomość



Alice Bílková

Vice President, Real Estate Asset Management

abilkova@marqlogistics.com

CzechyWęgry

+420 608 434 215

## GLP Park Brno Vyškov – Business Elevation in the Heart of Moravia

Just 20 minutes from Brno and directly connected to the D1 express road, GLP Park Brno Vyškov offers 40,000 m<sup>2</sup> of state-of-the-art logistics and industrial space. Designed for maximum operational efficiency, the park consists of two modern buildings with a 12-metre clear height and flexible office options – ideal for warehousing, light manufacturing, and distribution.

## Strategic Location and Workforce Potential

Its prime location ensures rapid connections across the Czech Republic and Central Europe – just 30 km to Brno, 155 km to Ostrava, and easy access to Slovakia, Austria, and Poland. With a labour pool of over 300,000 people within a 30-minute drive, businesses benefit from a strong and accessible workforce base.

## Sustainable and Future-Ready

Certified BREEAM Excellent, GLP Park Brno Vyškov is built with sustainability at its core – integrating energy-efficient systems, smart resource management, and eco-friendly materials. Combining cutting-edge design, green technology, and strategic positioning, this logistics park is where modern business meets long-term growth.

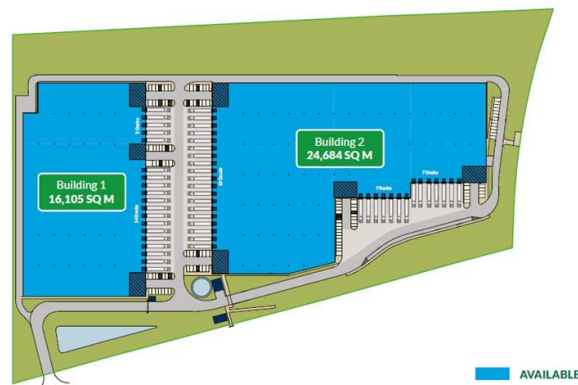

### CAŁKOWITA POWIERZCHNIA BUDYNKU

40,800 mkw

### DOSTĘPNA POWIERZCHNIA

40,800 mkw

### ADRES

7X7C+3R Vyškov, Vyškov 1, Czechia

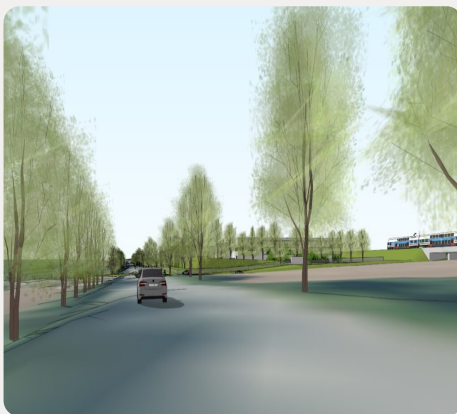

ZOBACZ PEŁNE SZCZEGÓŁY TEJ NIERUCHOMOŚCI NA

[HTTPS://EU.GLP.COM/PL/NIERUCHOMO%C5%9BCI/GLP-PARK-BRNO-VYSKOV/](https://eu.glp.com/pl/nieruchomo%C5%9BCI/GLP-PARK-BRNO-VYSKOV/)